

## AIRIUS MOUNTING GUIDELINES - Model 100

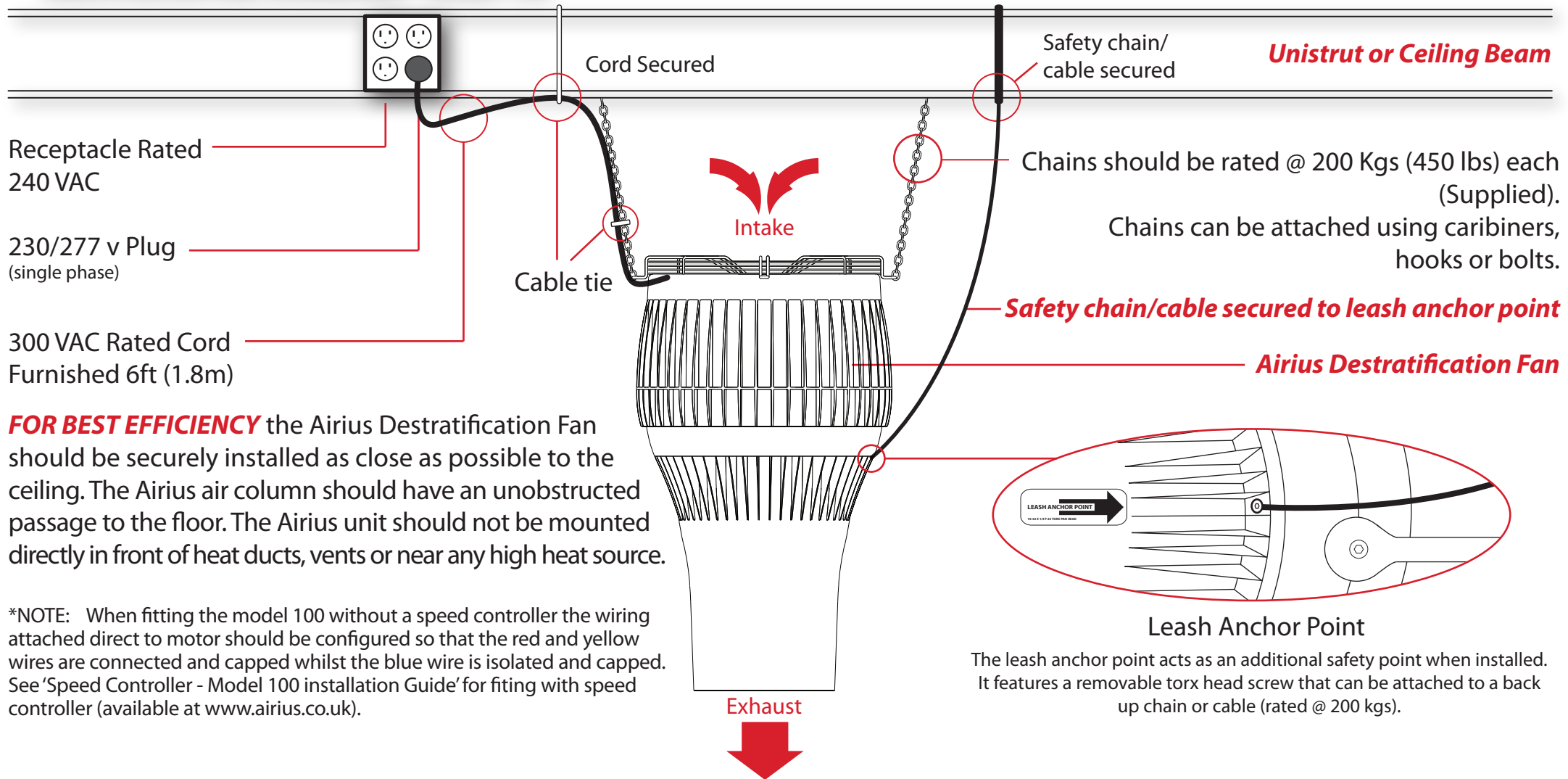

**FOR BEST EFFICIENCY** the Airius Destratification Fan should be securely installed as close as possible to the ceiling. The Airius air column should have an unobstructed passage to the floor. The Airius unit should not be mounted directly in front of heat ducts, vents or near any high heat source.

\*NOTE: When fitting the model 100 without a speed controller the wiring attached direct to motor should be configured so that the red and yellow wires are connected and capped whilst the blue wire is isolated and capped. See 'Speed Controller - Model 100 installation Guide' for fitting with speed controller (available at [www.airius.co.uk](http://www.airius.co.uk)).

## AIRIUS MOUNTING GUIDELINES - Model 100 (Angled)

